



Sensing Solutions since 1959

# 021-P000 Series Technical Data Sheet

## Junction Boxes

### Applications

- Protect conductors in threaded rigid conduit
- Act as pull and splice boxes
- Connect lengths of conduit and change conduit direction
- Provide access to conductors for maintenance and future system changes
- Act as mounting outlets for fixtures or sealing fittings (with appropriate covers)



021-P00023



021-P00041



021-P00042



021-P00055

### Custom Solutions

At times, OEMs, end users or military specifiers require a customized solution or sample product to test. Madison Company can design, manufacture and ship a custom switch or sensor in just six business days. Simply communicate the quantity and requirements to our technical sales staff. We will quote the product to establish budget and ROI. Following the quote approval, Madison engineers will design the switch or sensor that satisfies the application specifications, and provide proof of concept. Upon approval, we will build and ship the product or sample.

### Dimensional Drawings

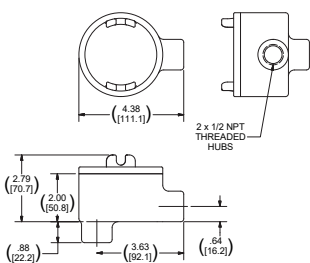

021-P00023

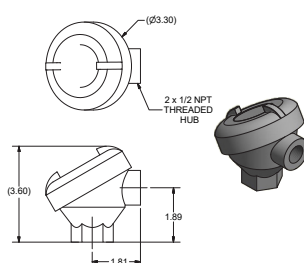

021-P00041

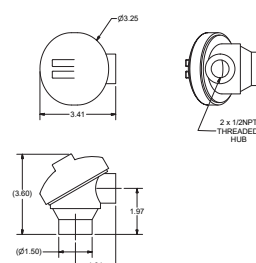

021-P00042

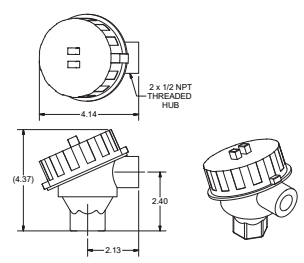

021-P00055

**View in-stock products ready to ship today at [Madisonco.com/buy](http://Madisonco.com/buy)**

Madison Company, Inc.  
27 Business Park Drive  
Branford, CT 06405

203-488-4477 or 800-466-5383  
info@madisonco.com  
www.madisonco.com



# 021-P000 Series Technical Data Sheet

## Junction Boxes

Junction Box Specifications				
Model	Approvals	Ingress Protection	Mounting	Other Wetted Materials
021-P00023	UL, CSA, NEC and CEC: Class 1, Division 1 & 2, Groups C and D	NEMA 3, 4, 7 CD, 9 EFG	1/2" NPT	Body: Cast Iron, Cover: Aluminum
021-P00041		NEMA 4X (IP68)	1/2" NPT	Aluminum
021-P00042		NEMA 4 (IP65)	1/2" NPT	Nylon
021-P00055	FM, FMC, CSA, NEC and CEC: Class 1, Division 1, Groups A, B, C and D	NEMA 4 (IP65)	1/2" NPT	Aluminum

***View in-stock products ready to ship today at [Madisonco.com/buy](http://Madisonco.com/buy)***



Madison Company, Inc.  
27 Business Park Drive  
Branford, CT 06405

203-488-4477 or 800-466-5383  
info@madisonco.com  
www.madisonco.com

