



Sensing Solutions since 1959

# R3 Series Technical Data Sheet

## Radar Level Sensors



R3-100C232-ATE

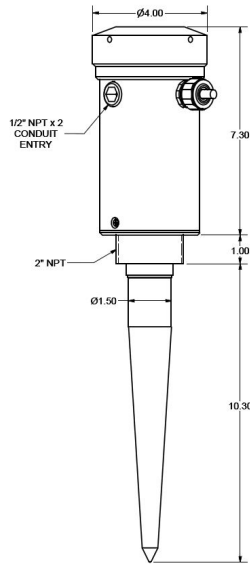

### Applications

- Single frequency continuous level measurement over larger ranges of liquids containing sludge, biomass, dust, foam and coatings
- Ideal for turbulent conditions, uneven surfaces, pressure and vacuum
- RS232 or RS485 comm port options
- 50 or 100 ft range

### Custom Solutions

At times, OEMs, end users or military specifiers require a customized solution or sample product to test. Madison Company can design, manufacture and ship a custom switch or sensor in just six business days. Simply communicate the quantity and requirements to our technical sales staff. We will quote the product to establish budget and ROI. Following the quote approval, Madison engineers will design the switch or sensor that satisfies the application specifications, and provide proof of concept. Upon approval, we will build and ship the product or sample.

### Related Products



R3-100C485-ATE



R3-50C232-ATE



R3-50C485-ATE

**View in-stock products ready to ship today at [Madisonco.com/buy](http://Madisonco.com/buy)**

Madison Company, Inc.  
27 Business Park Drive  
Branford, CT 06405

203-488-4477 or 800-466-5383  
info@madisonco.com  
www.madisonco.com



# R3 Series Technical Data Sheet

## Radar Level Sensors

Radar Level Sensor Specifications								
Model	Accuracy	Approvals	Frequency	Input Voltage	Max. Temp	Mounting	Output	Sensing Range
R3-100C232-ATE	±0.25% of Full Scale	FCC, FM, CSA	6.3 GHz	12-30 VDC, R load = (Vs-6)/24 mA	-40 to 140°F (-40 to 60°C)	2" NPT Pipe Plug	4-20 mA, 6.1 uA resolution; 750 Ω (isolated on 4-wire models only), RS232 communications port	100' (30.5 m)
R3-100C485-ATE	±0.25% of Full Scale	FCC, FM, CSA	6.3 GHz	12-30 VDC, R load = (Vs-6)/24 mA	-40 to 140°F (-40 to 60°C)	2" NPT Pipe Plug	4-20 mA, 6.1 uA resolution; 750 Ω (isolated on 4-wire models only); RS485 communications port	100' (30.5 m)
R3-50C232-ATE	±0.25% of Full Scale	FCC, FM, CSA	6.3 GHz	12-30 VDC, R load = (Vs-6)/24 mA	-40 to 140°F (-40 to 60°C)	2" NPT Pipe Plug	4-20 mA, 6.1 uA resolution; 750 Ω (isolated on 4-wire models only), RS232 communications port	50' (15.2 m)
R3-50C485-ATE	±0.25% of Full Scale	FCC, FM, CSA	6.3 GHz	12-30 VDC, R load = (Vs-6)/24 mA	-40 to 140°F (-40 to 60°C)	2" NPT Pipe Plug	4-20 mA, 6.1 uA resolution; 750 Ω (isolated on 4-wire models only); RS485 communications port	50' (15.2 m)

Model	Beam Angle	Calibration	Ingress Protection	Other Wetted Materials	Resolution	Transmitter Power
R3-100C232-ATE	8°	Programmable via communications port or Push Button	NEMA 4 (IP65)	Aluminum Body, Teflon Antenna	± 0.1"	50 uW average
R3-100C485-ATE	8°	Programmable via communications port or Push Button	NEMA 4 (IP65)	Aluminum Body, Teflon Antenna	± 0.1"	50 uW average
R3-50C232-ATE	8°	Programmable via communications port or Push Button	NEMA 4 (IP65)	Aluminum Body, Teflon Antenna	± 0.1"	50 uW average
R3-50C485-ATE	8°	Programmable via communications port or Push Button	NEMA 4 (IP65)	Aluminum Body, Teflon Antenna	± 0.1"	50 uW average

Note: OPTIONS: 1.5" or 2" NPT PTFE decoupler for high-temperature applications / Antenna extension : 6" or 8" / Sanitary PTFE antenna

**View in-stock products ready to ship today at [Madisonco.com/buy](http://Madisonco.com/buy)**



Madison Company, Inc.  
27 Business Park Drive  
Branford, CT 06405

203-488-4477 or 800-466-5383  
info@madisonco.com  
www.madisonco.com

